

### Why complicated, when it can be simple

Bicycles with tyre widths up to 38 mm have ample space in our model 3600. Whether on the wall or set in concrete, there is no easier way to park a bicycle.

Article number	EAN	Width	Height	Depth
105100046	4250366529004	68 mm	345 mm	215 mm

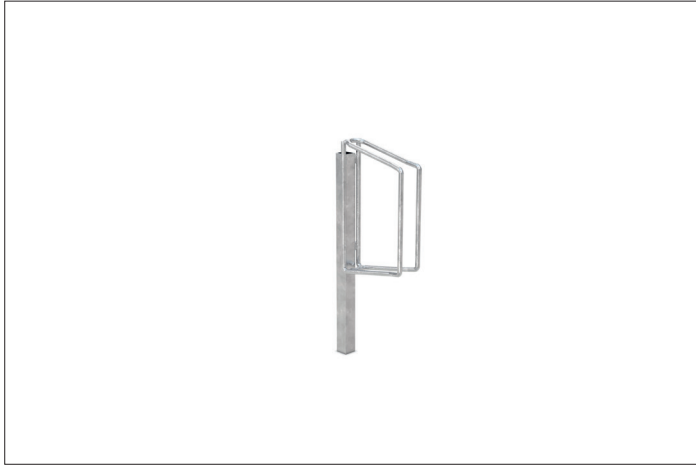

Parking spaces	1
Colour	Silver
Weight	5,20 kg
Construction type	Welded / ready assembled
Base material	Steel
Mounting type	Set in concrete
Bike spacing	500 mm
Tyre width	38 mm
Configuration	One-sided

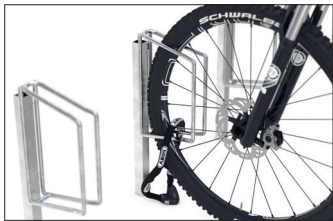

The single parker 3600 solves many parking problems on buildings. Simply measure the available space, clarify the wall composition and attach. If no wall is available, you can also simply set the

bicycle parking system in concrete. The hot-dip galvanised steel tube construction is robust and withstands all weather conditions.

- + Robust, corrosion protected steel construction
- + Concrete or wall mounting
- + For bicycles with 38 mm tire width
- + Space-saving
- + Cost-effective

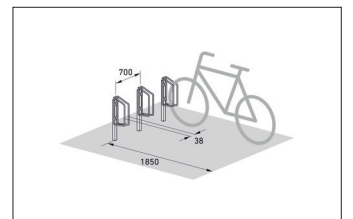
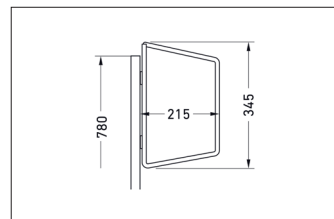

Further information on our products and contact options at: [www.wsm.eu/en](http://www.wsm.eu/en).  
No guarantee can be given for the completeness and correctness of the data and illustrations.