

The bicycle parking system where nothing can buckle

With its functional frame rests and steel eyelets, this free-standing bicycle leaning system also protects highest-quality bicycles from damage and theft.

Article number	EAN	Width	Height	Depth
105700079	4250366511566	1400 mm	856 mm	944 mm

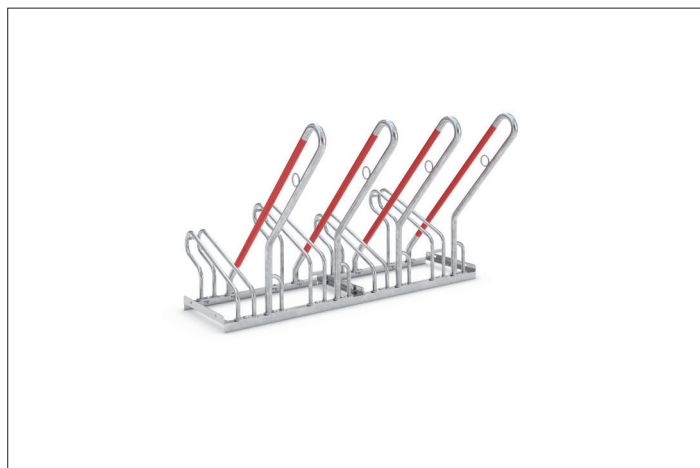

Parking spaces	4
Colour	Silver
Weight	30,80 kg
Construction type	Screwed / assembly kit
Base material	Steel
Mounting type	On the floor
Bike spacing	350 mm
Tyre width	55 mm
Configuration	One-sided
Positioning space depth	1850 mm

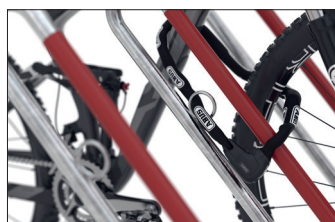

The striking detail of this free-standing bicycle parking system is the diagonal frame rest sheathed in signal red plastic. It protects every bicycle or e-bike against wanton or accidental wheel buckling and consequential damage to the rims. Integrated steel eyelets provide optimal theft protection. The spacing between

hoops is generously laid out and ideal for bicycles with up to 55 mm wide tyres. The stanchion thus offers you or your employees, customers and guests the highest level of parking convenience. Of course, the system is prefabricated for ground mounting and series connection.

- + Free-standing, bolted tubular steel construction
- + Ample plastic-sheathed frame rests
- + Integrated eyelets for preventing theft
- + Prefabricated for row/series connection

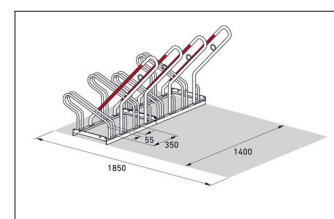
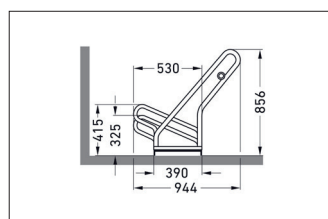

Further information on our products and contact options at: www.wsm.eu/en.
 No guarantee can be given for the completeness and correctness of the data and illustrations.