

Recommended for bicycles in need of a rest

This free-standing bike leaning system offers comfortable frame rests and steel eyelets to protect even the highest quality bicycles from damage and theft.

Article number	EAN	Width	Height	Depth
105700154	4250366517520	3000 mm	817 mm	1205 mm

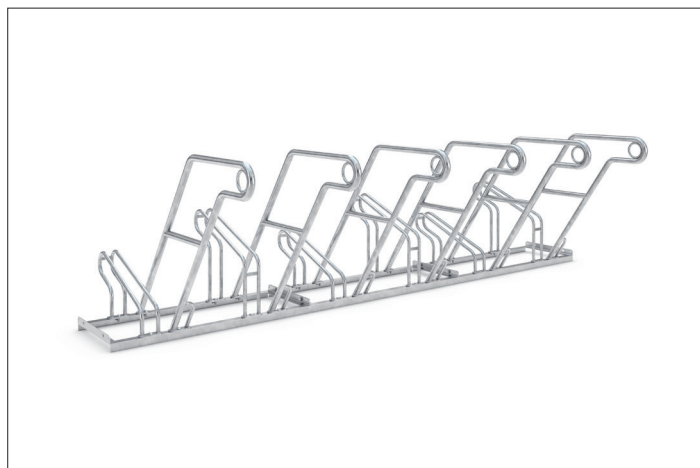

Parking spaces	6
Colour	Silver
Weight	59,40 kg
Construction type	Screwed / assembly kit
Base material	Steel
Mounting type	On the floor
Tyre width	55 mm
Configuration	One-sided

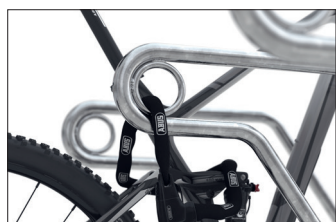

This free-standing bicycle parking system welcomes its users with generous waist-high horizontal frame rests; an arrangement that makes the safe parking of even highest-quality bicycles such as pedelecs and e-bikes even more comfortable. One can also reach the round steel eyelets integrated into the frame rests to which bicycle locks can be securely attached without bending over. With its single-sided spacing between bikes of 500 mm

and 540 mm double-sided, the Parker with Frame Rest 2600 XBF offers the highest level of parking comfort for employees, customers and guests or for its owner. The alternating low/high hoop settings save valuable space. The system is prefabricated for ground mounting and series connection. Ground mounting brackets included.

- + Free-standing, bolted tubular steel construction
- + Protection through comfortable frame rests
- + Integrated eyelets to prevent theft
- + Prefabricated for row/series connection

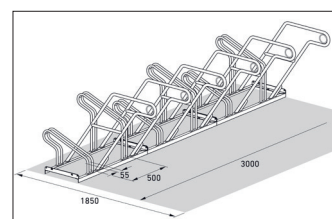
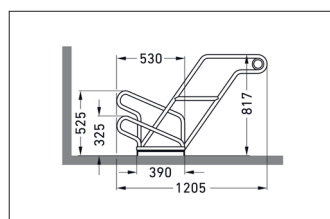

Further information on our products and contact options at: www.wsm.eu/en.
 No guarantee can be given for the completeness and correctness of the data and illustrations.