

2522 XBF

Bicycle parking with the best recommendation

With its functional frame rests and steel eyelets, this free-standing bicycle leaning system also protects top-quality bicycles from damage and theft.

| Article number | EAN | Width | Height | Depth |
|----------------|---------------|---------|--------|---------|
| 105700178 | 4250366528526 | 3240 mm | 856 mm | 1200 mm |

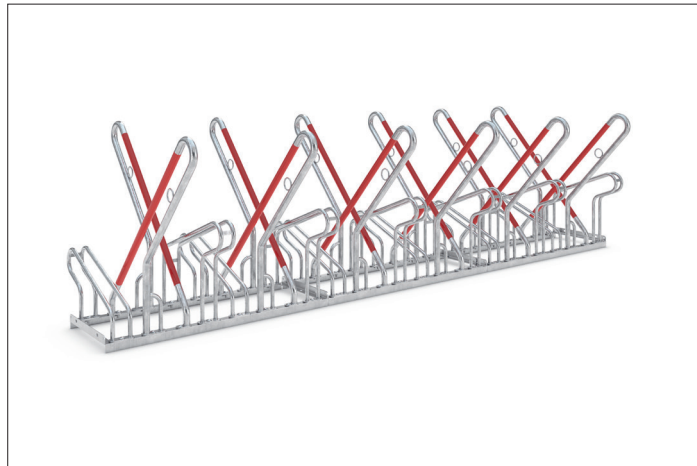

| | |
|-------------------------|------------------------|
| Parking spaces | 12 |
| Colour | Silver |
| Weight | 82,30 kg |
| Construction type | Screwed / assembly kit |
| Base material | Steel |
| Mounting type | On the floor |
| Bike spacing | 500 mm |
| Tyre width | 55 mm |
| Configuration | Two-sided |
| Positioning space depth | 3200 mm |



The striking detail of this free-standing bicycle parking system is the diagonal frame rest sheathed in signal red plastic. It protects every bicycle or e-bike against wanton or accidental wheel twisting and consequential damage to the rims. Integrated steel eyelets provide optimal theft protection. The spacing between hoops is generously laid out and ideal for bicycles with up to

55 mm wide tyres. Spacing is 500 mm or 540 mm for double-sided parking. The stanchion thus offers you or your employees, customers and guests the highest level of parking convenience. Optionally single or double-sided. Of course, the system is prefabricated for ground mounting and series connection. Ground mounting brackets included.

- + Free-standing, bolted tubular steel construction
- + Ample plastic-sheathed frame rests
- + Integrated eyelets for preventing theft
- + Prefabricated for row/series connection

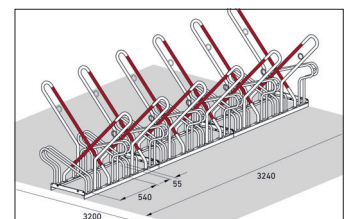
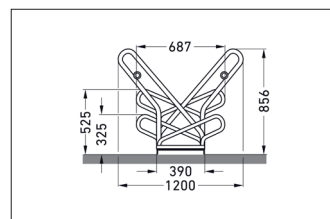

Further information on our products and contact options at: www.wsm.eu/en.
No guarantee can be given for the completeness and correctness of the data and illustrations.