

The epitome of secure bicycle parking

Leaning system with extra-secure parking hoops, frame rests and steel eyelets to protect even the highest quality bikes from damage and theft.

Article number	EAN	Width	Height	Depth
105800058	4250366515267	1400 mm	856 mm	867 mm

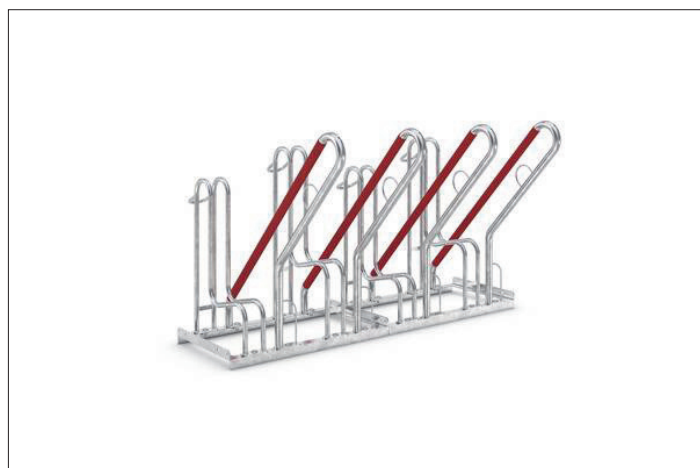

Parking spaces	4
Colour	Silver
Weight	32,00 kg
Construction type	Screwed / assembly kit
Base material	Steel
Mounting type	On the floor
Bike spacing	350 mm
Tyre width	55 mm
Configuration	One-sided
Positioning space depth	1850 mm

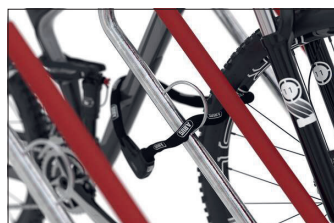

Particularly safe, with vertical format parking hoops, plastic-sheathed frame-rest and steel eyelets to protect even the highest quality bicycles from damage and theft – that's what characterises the Parker with Frame Rest 4500. This makes safe parking for high-quality bicycles such as pedelecs and e-bikes even more comfortable. The round steel eyelets integrated into the frame rests make locking and unlocking particularly easy and secure.

All in all, the highest level of parking comfort for your customers, employees and guests or yourself. The alternating low/high hoop setting saves valuable space. The system is prefabricated for ground mounting and series connection. Meets the requirements for theft protection according to DIN 79008:2016-05 point 7.2

- + Free-standing, bolted tubular steel construction
- + Vertical parking hoops and sheathed frame rest
- + Integrated eyelets to prevent theft
- + Prefabricated for row/series connection

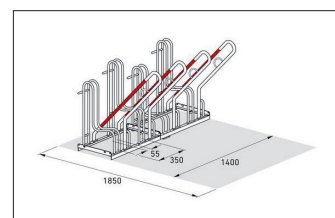
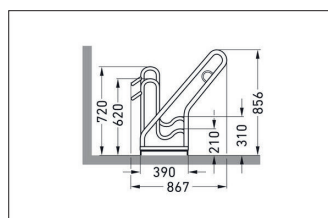

Further information on our products and contact options at: www.wsm.eu/en.
No guarantee can be given for the completeness and correctness of the data and illustrations.